



- NOTES:
1. REFER TO TXDOT STANDARD DETAIL BC-03 FOR BARRIERS AND CONSTRUCTION STATIONS.
 2. REFER TO TXDOT STANDARD DETAIL TCP (2-1)-98 FOR SPACING DISTANCES.
 3. ALL CONSTRUCTION TRAFFIC SHALL TAKE PLACE DURING NIGHTTIME HOURS.

LIMITS OF CONSTRUCTION



REFER TO TXDOT DETAIL TCP12-21-03 FOR THE CLOSURE OF ONE TRAFFIC LANE WITH FLAGGERS PRESENT DURING CONSTRUCTION THIS PHASE

REFER TO TXDOT DETAIL TCP12-21-03 FOR THE CLOSURE OF ONE TRAFFIC LANE WITH FLAGGERS PRESENT DURING CONSTRUCTION THIS PHASE



CHANNELIZING DEVICES

CENTER STREET

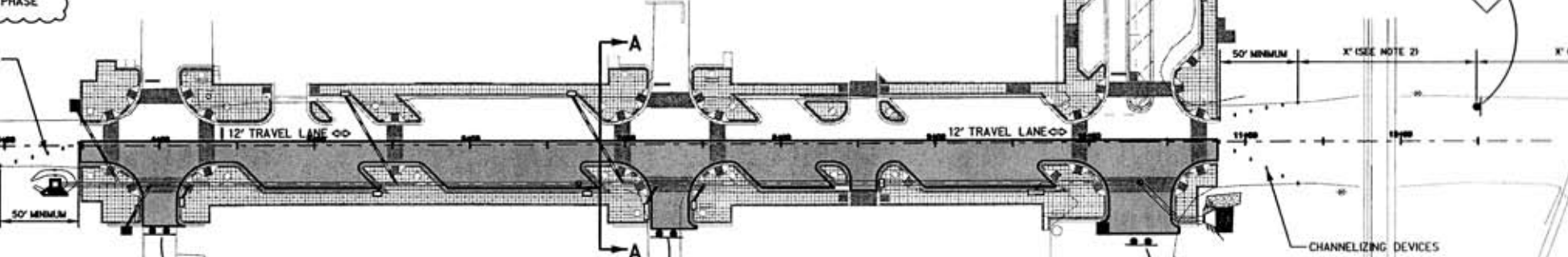

BURLESON STREET

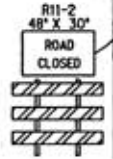
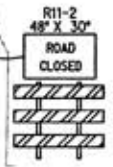

MAIN STREET

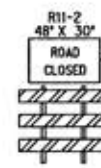

FRONT STREET

CHANNELIZING DEVICES



SECTION A-A
TYPICAL CROSS SECTION - PHASE VI
N.T.S.

