

# Water / Sewer Line Depths

## Water lines and Wastewater Conflict Concerns on Burleson

### Water:

- \* Miller
- \* Center
- \* Lockhart - Spot dig East side of road - 3 ft 5 inches deep at the ditch or low spot *crossings*
- \* Blanco - Approximate 30' North of Blanco (6" water main on West side of Burleson)  
It is 15" deep and under edge of existing asphalt *parallel*
- \* Austin
- \* North
- \* Schlemmer - Spot dig East side of road - 3 ft deep *crossing*
- \* St. Anthony's
- \* Alley between Moreno and Tenorio- Spot dig East side of road - Waterline across Burleson 4 ft 3 inches deep *crossings*
- \* Star of Texas- Spot dig East side of road - 3 ft 9 inches deep
- \* Bellair

**NOTE:** Service lines at 206 and 408 B North Burleson is 14" and 15" under pavement. *crossings*

### Wastewater:

- \* Alley between Center and Lockhart- 8" from road 6'2" deep
- \* Alley between Lockhart and Blanco - 8' from road 5' 2" deep
- \* Alley between Blanco and Austin - Have never found a manhole there.
- \* Alley between Austin and North - East side of road 8' 11". West side of road 8' 10", 7' 3" deep
- \* Schlemmer - 11'6" from road 7' deep
- \* Alley between Moreno and Tenorio - 10' from road. 6' 10" deep

①

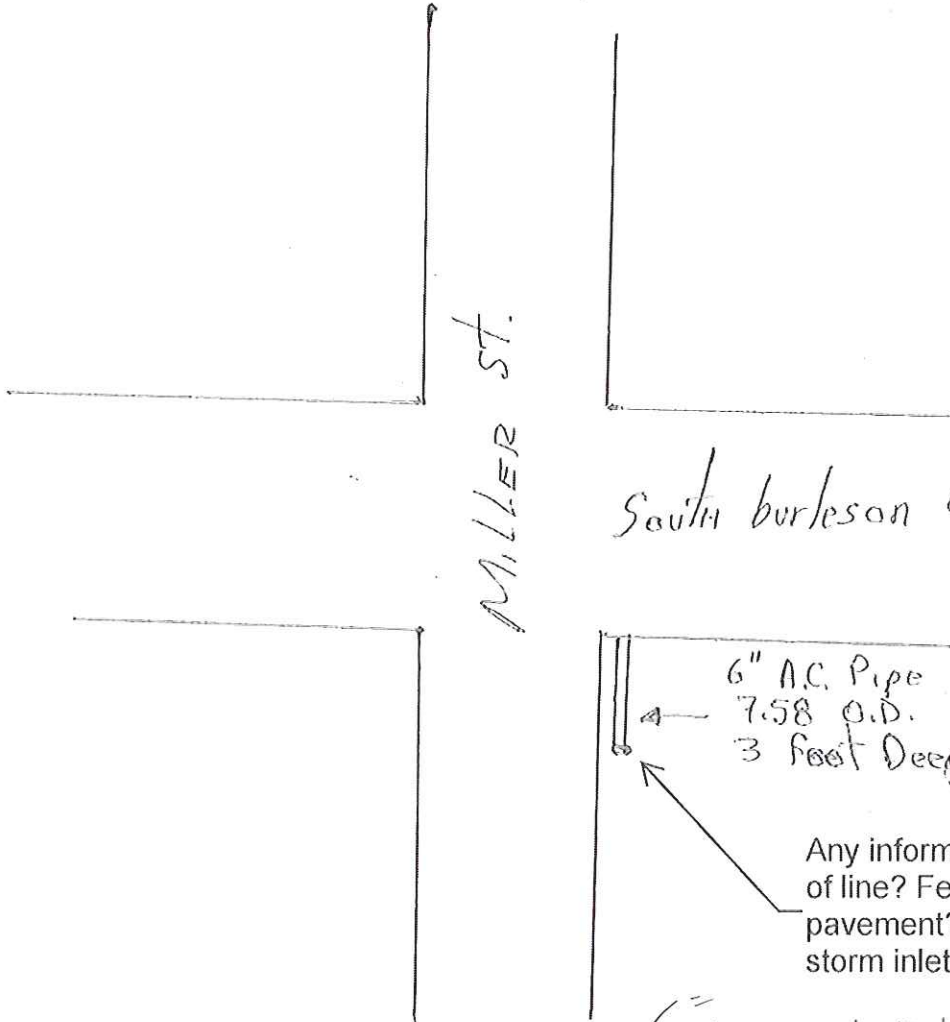

MILLER ST.

South Burlison Rd.

6" A.C. Pipe  
7.58 O.D.  
3 foot Deep

Any information on location of line? Feet away from pavement? Feet away from storm inlet?

6" WATER LINE 12 FEET TO EDGE OF STORM INLET. AND 22 FEET TO Miller'S Pavement

(2)

8" A.C. Pipe  
4.60 O.D.  
3 feet Deep  
15 feet F/Pavement



Center Street

X4 - NO WATER MAIN FOUND

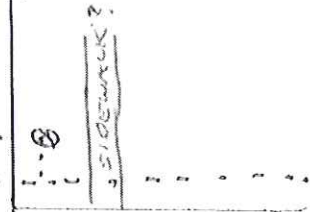

(X) FIRE Hydrant

North Burleson Rd.

Please confirm; 15'  
from Center Street?  
How far back from  
North Burleson?

Yes, is 15' from Center St.

UNKNOWN  
WATER LN. MAY  
CROSS CENTER ST.  
OR MAY END BEFORE  
INLET

8" A.C. Pipe  
9.54 O.D.  
2' 8" Deep

How far is this line off  
the pavement?

33' 6" From Pavement  
off CENTER ST.

3

Center street

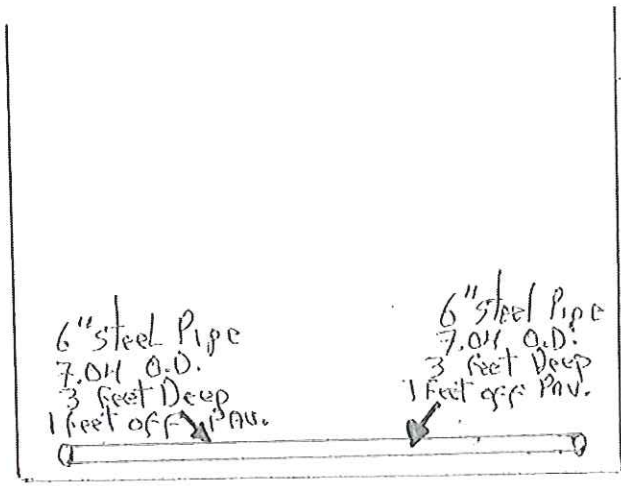

North burleson Rd.

LOCKHART ST.

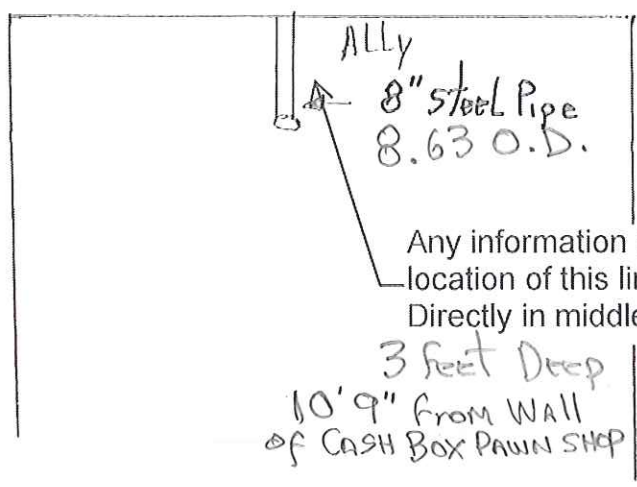

Any information on location of this line?  
 Directly in middle of ally?  
 3 feet Deep  
 10' 9" from Wall  
 of CASH BOX PAWN SHOP

5

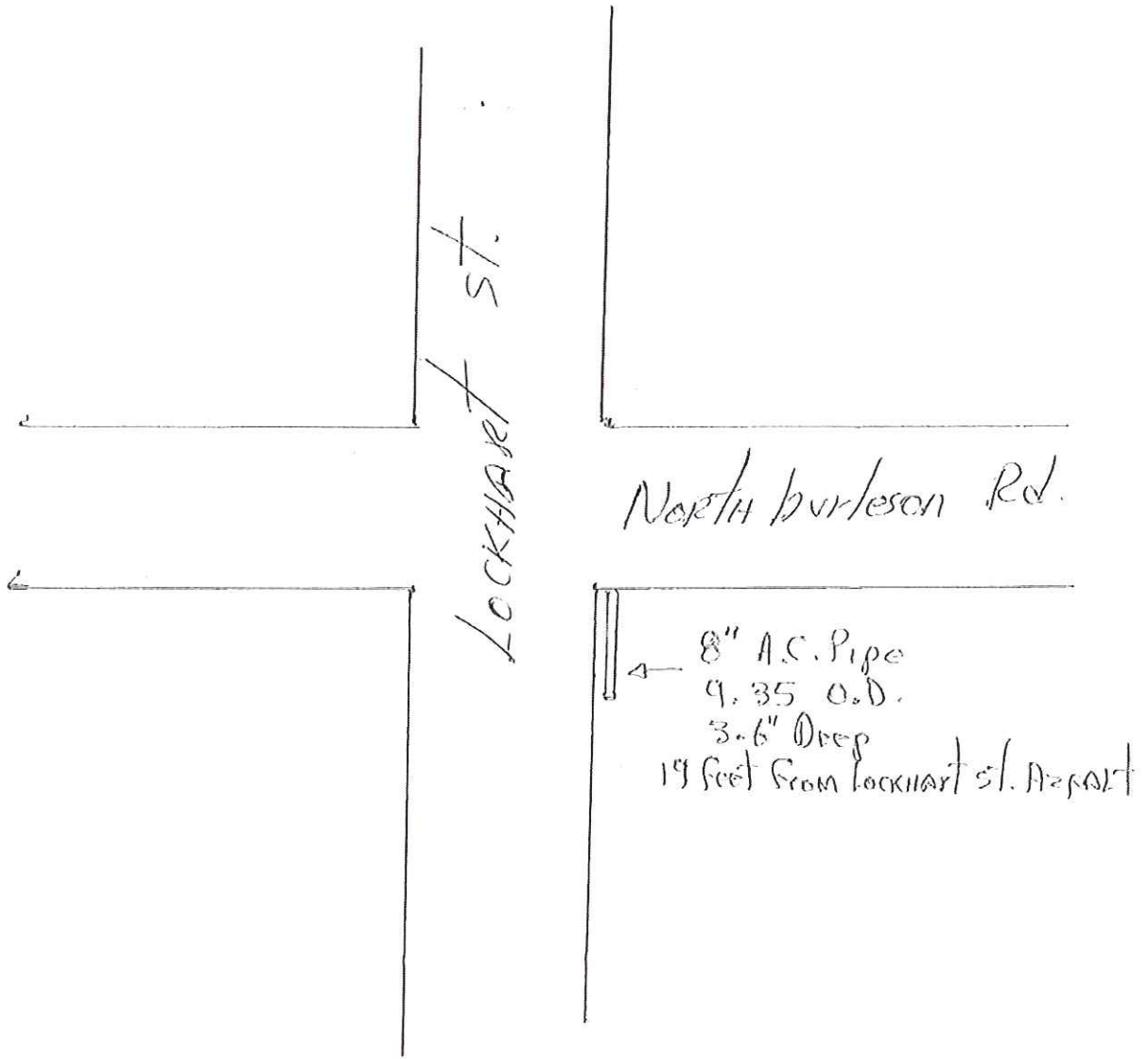

North Burleson Rd.

8" A.C. Pipe  
4.35 O.D.  
3.6" Deep  
19 feet from Lockhart St. Airport

(4)

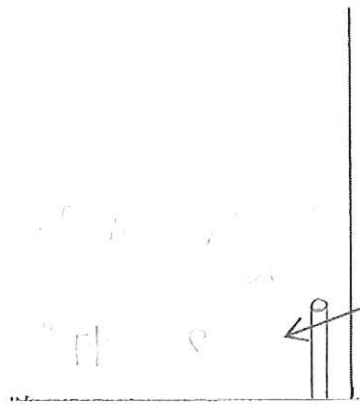

9.35 O.D.  
8" AC Pipe  
23' From Blanco St. Asfalt  
5 Feet Deep

Does 8" line extend to the other side of North Burleson? We show this in our plans. Is it the same distance from the street?

Blanco St.

North burleson Rd.

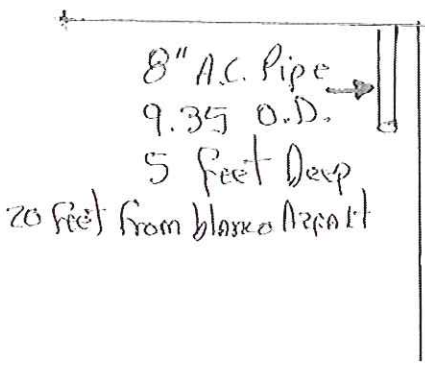

8" AC. Pipe  
9.35 O.D.  
5 Feet Deep  
20 feet from blanco Asfalt

6

Blanco st.

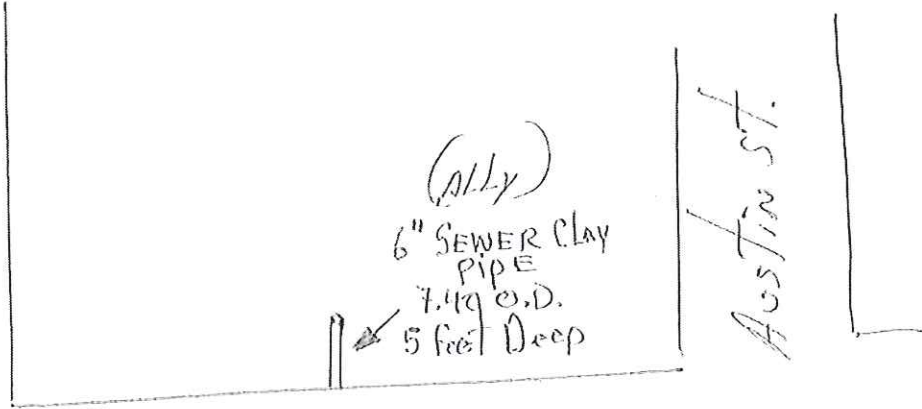

North Burleson →

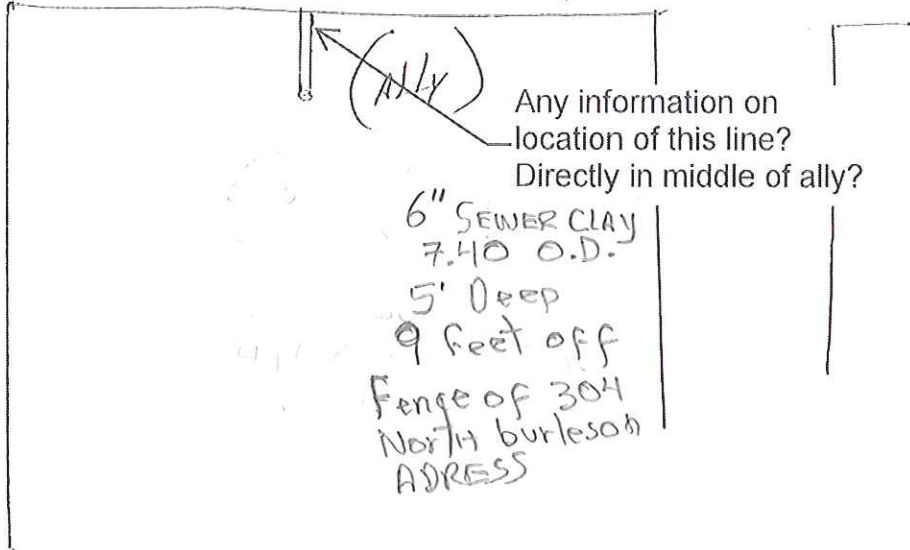

7

Does 8" line extend to the other side of North Burlison. We show a 6" on this side.

3 feet off Burlison Asphalt

8" A.C. Pipe  
5 feet Deep

8" A.C. pipe  
9.40 O.D.  
5' 6" feet Deep

Right Under Curb

Austin St.

6" A.C. Pipe

15 feet off Austin St. Asphalt

3' off Burlison Asphalt

Burlison St. North →

Water Pipe is not on this side of Street

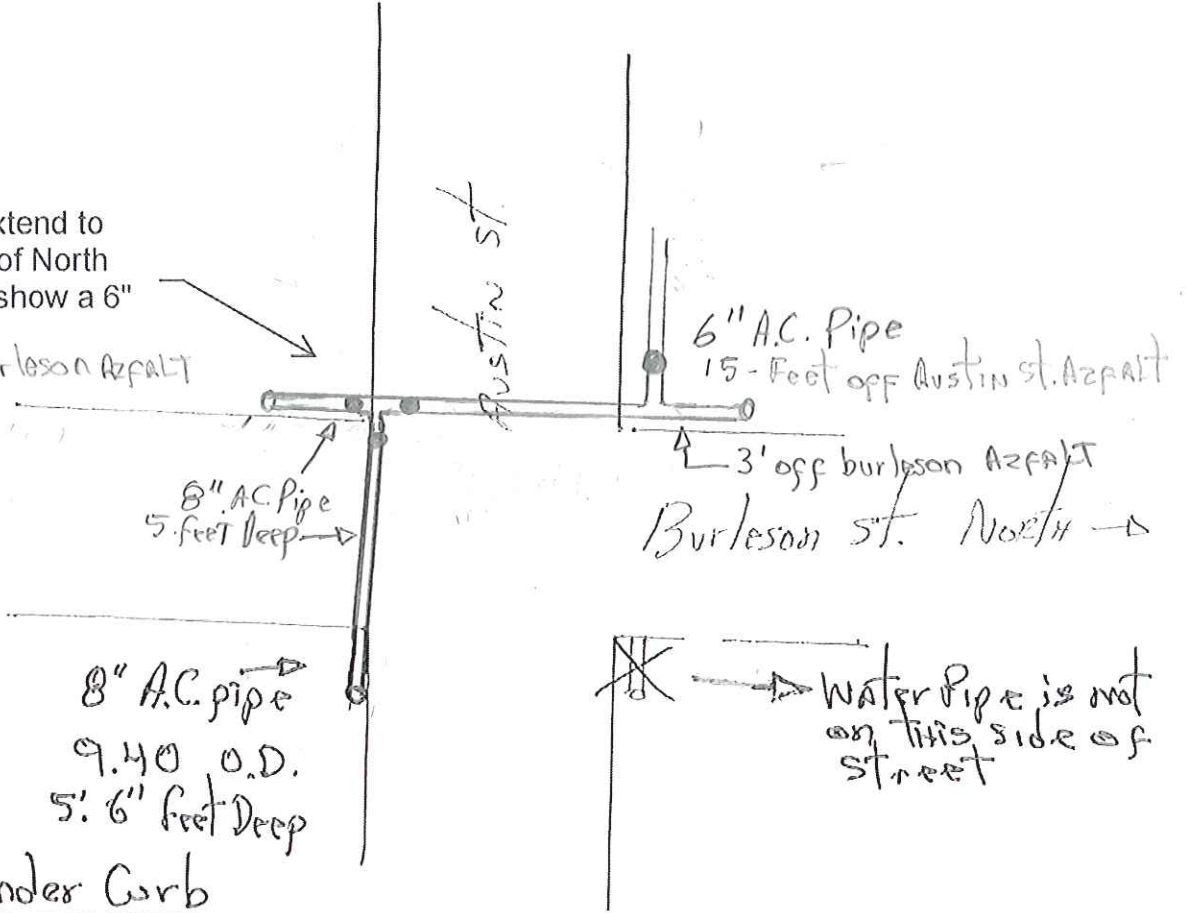



North St.

6" A.C. Pipe  
7.22 O.D.  
3'6" feet Deep  
9' off PAVEMENT

North Burlington →

No  
Water Pipe → X  
found on this  
side of St.

6" A.C. pipe  
7.24 O.D.  
2'10" feet Deep

How far away from pavement  
is this line? We show  
approximately 10' off  
pavement on each side.

9' OFF PAVEMENT

SCHLEEMER ST

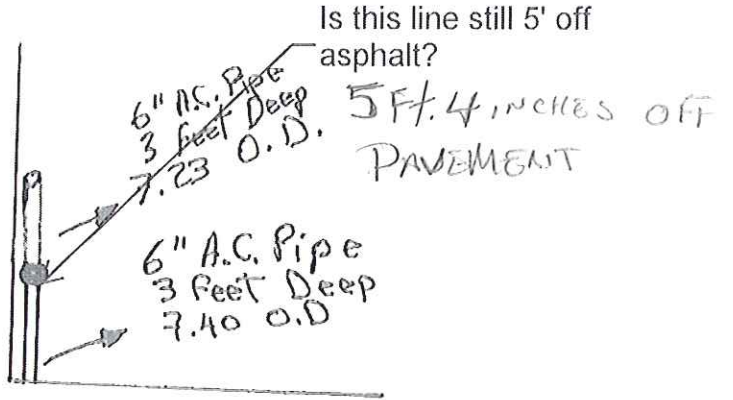

North Burlington →

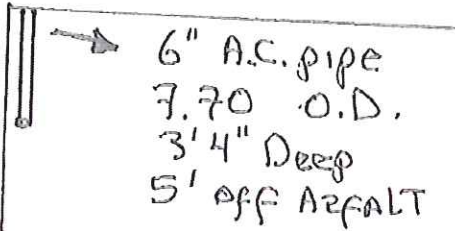

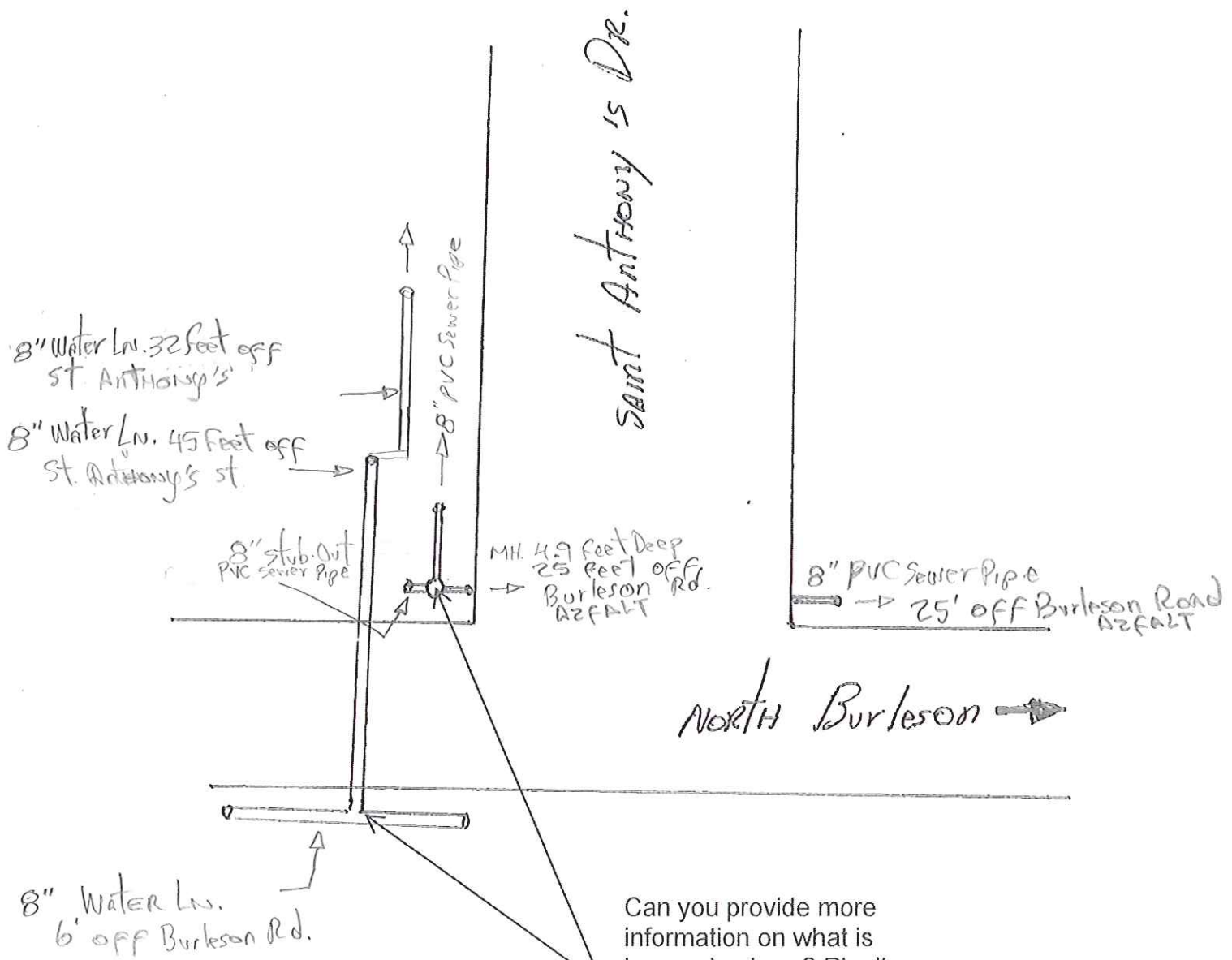

Can you provide more information on what is happening here? Pipeline sizes, if connections between these two areas are made, locations off pavement?

north burleson →

NO WATER  
PIPE FOUND  
ON THIS SIDE  
OF STREET → X

moreno st.

6" P.V.C. Water Pipe  
6.96 O.D.  
3' 6" feet Deep  
7 feet off Moreno St.

Ties in At St. Anthony's Street

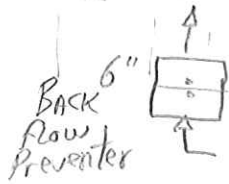

Saint Anthony's CHURCH

6" Water Valves Possible For Fire Protection CHURCH For Fire LN.

Is 6" or 8" line required here?  
Is a backflow prevention fire vault required? NO

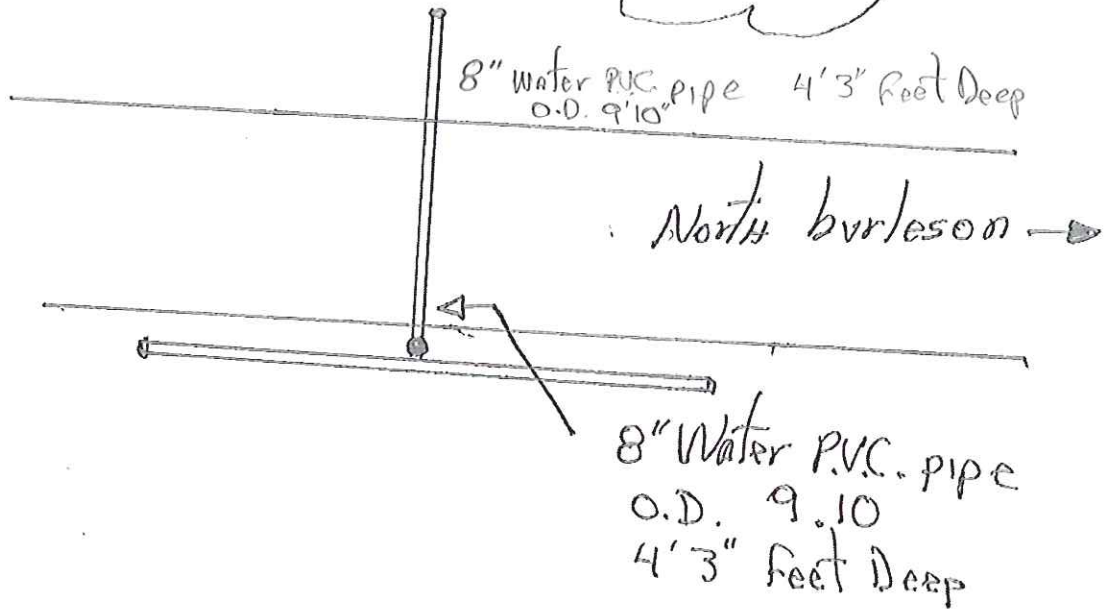

North burleson →

Tenorio St.

4" P.V.C. Water Pipe  
← 4.80 O.D.  
8 feet from Tenorio St.  
3 feet Deep

North burleson →

SELVERA ST.

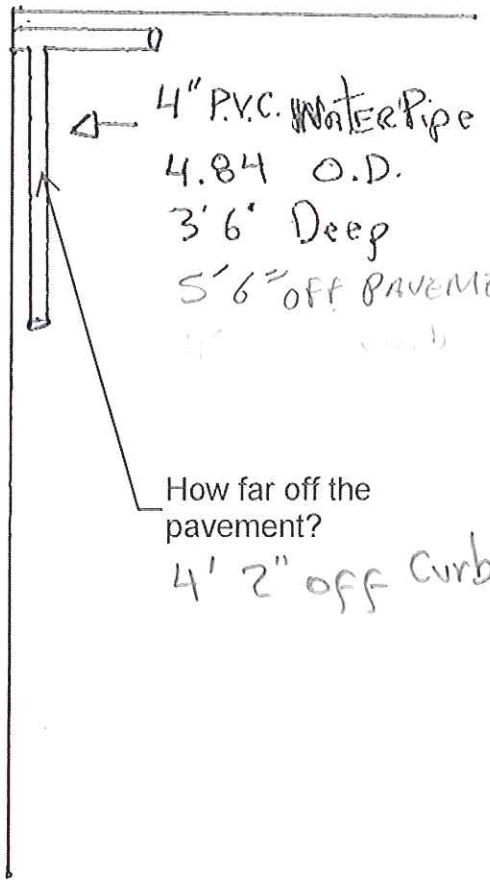

4" P.V.C. WATER PIPE  
4.84 O.D.  
3'6" Deep  
5'6" OFF PAVEMENT

How far off the pavement?  
4' 2" off Curb

STAR OF TEXAS

North burleson →

4" P.V.C. Water Pipe  
4.90 O.D.  
3 Feet Deep  
7 feet off  
Barrera St.

Barrera St.



We show this as a 8"  
WL. Is that correct?  
How far off pavement?

8" = PVC WL  
5 FEET 7 INCHES DEEP  
7 FEET TO EDGE OF PAVEMENT  
3 FEET TO EDGE OF CURB

STAR OF TEXAS

Northburleson →

Barrera street

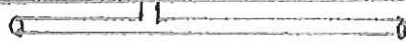

We show this as a 8"  
WL. Is that correct?  
How far off pavement?

8" WL  
4 FT 9 INCHES DEEP  
3 FT OFF CURB  
5 FT OFF PAVEMENT

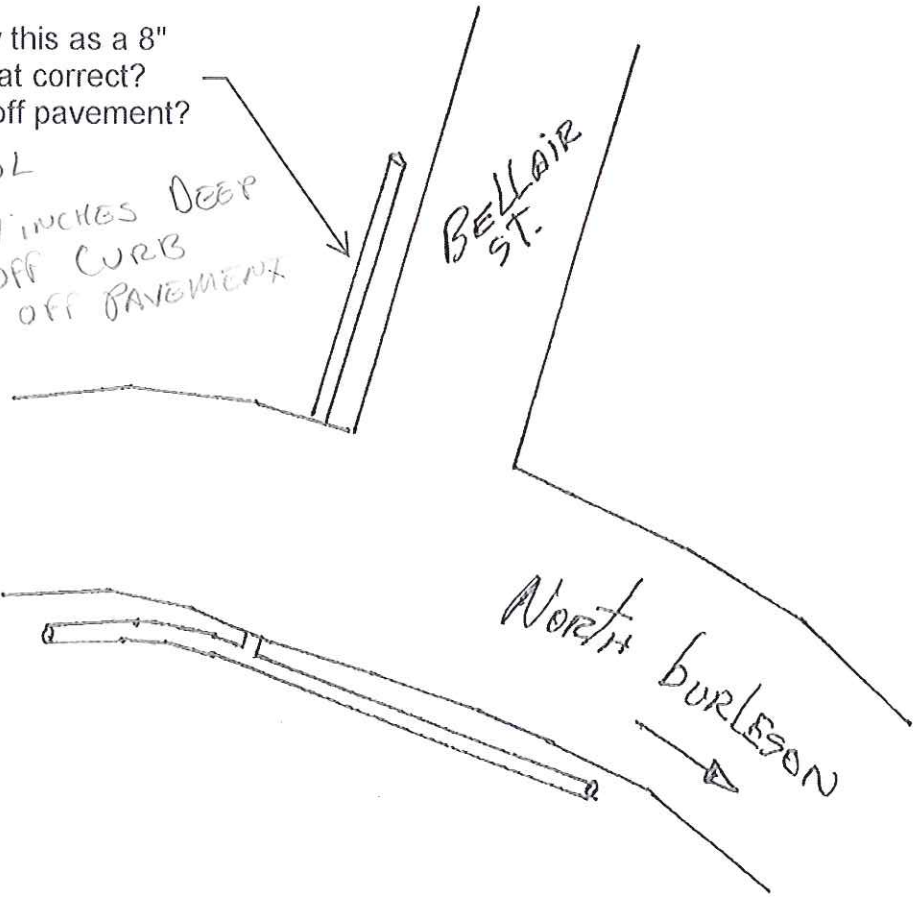

Spring  
Branch

North Burlison →

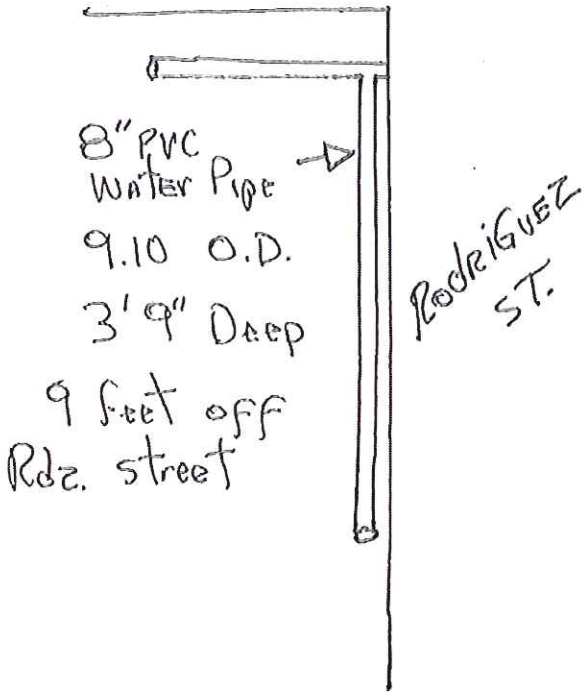

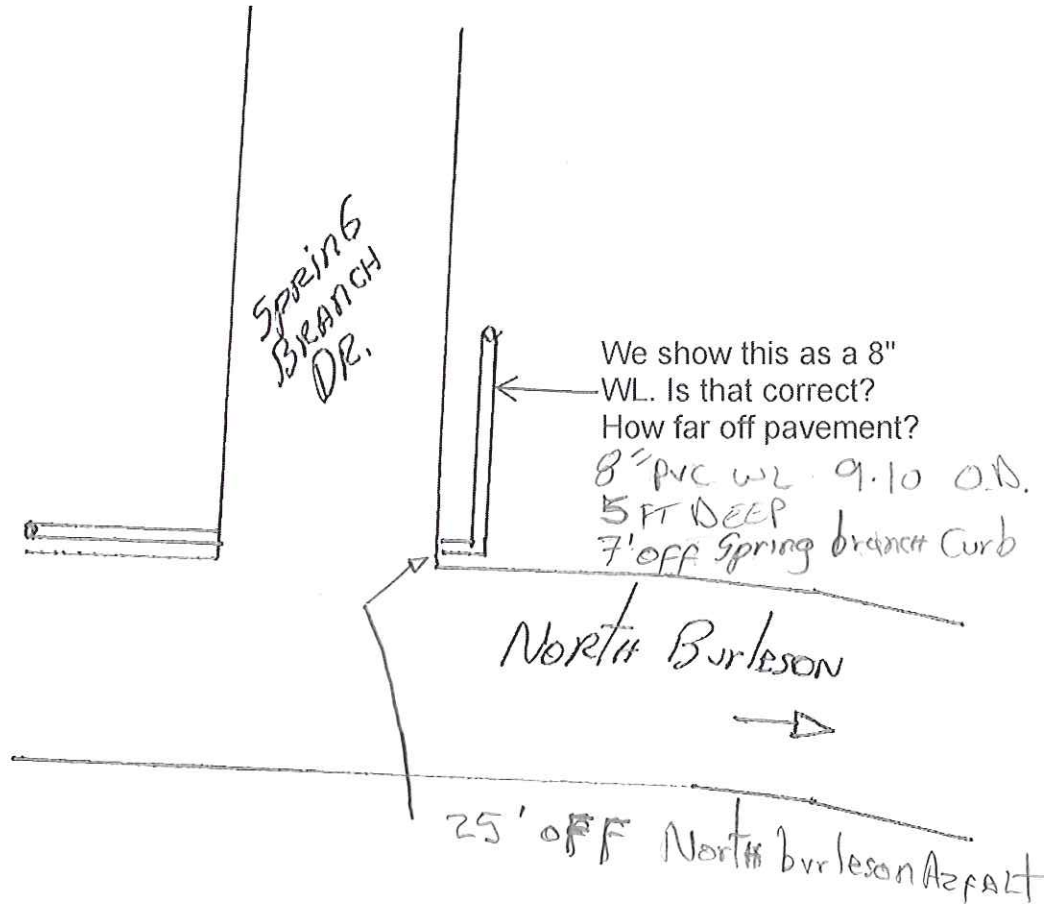

Spring  
BRANCH  
DR.

SEWER M.H.  
FOUND  
10'6" off Asfalt  
from burleson Rd.

M.H.

NORTH BURLESON  
→

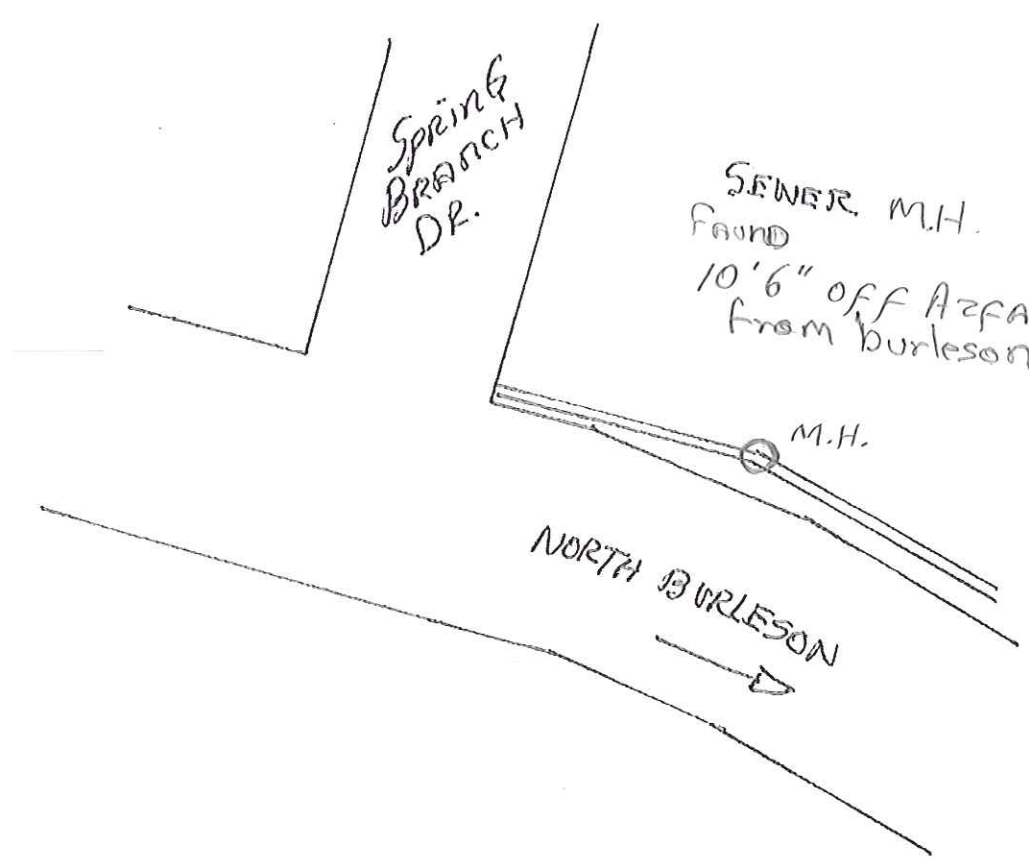

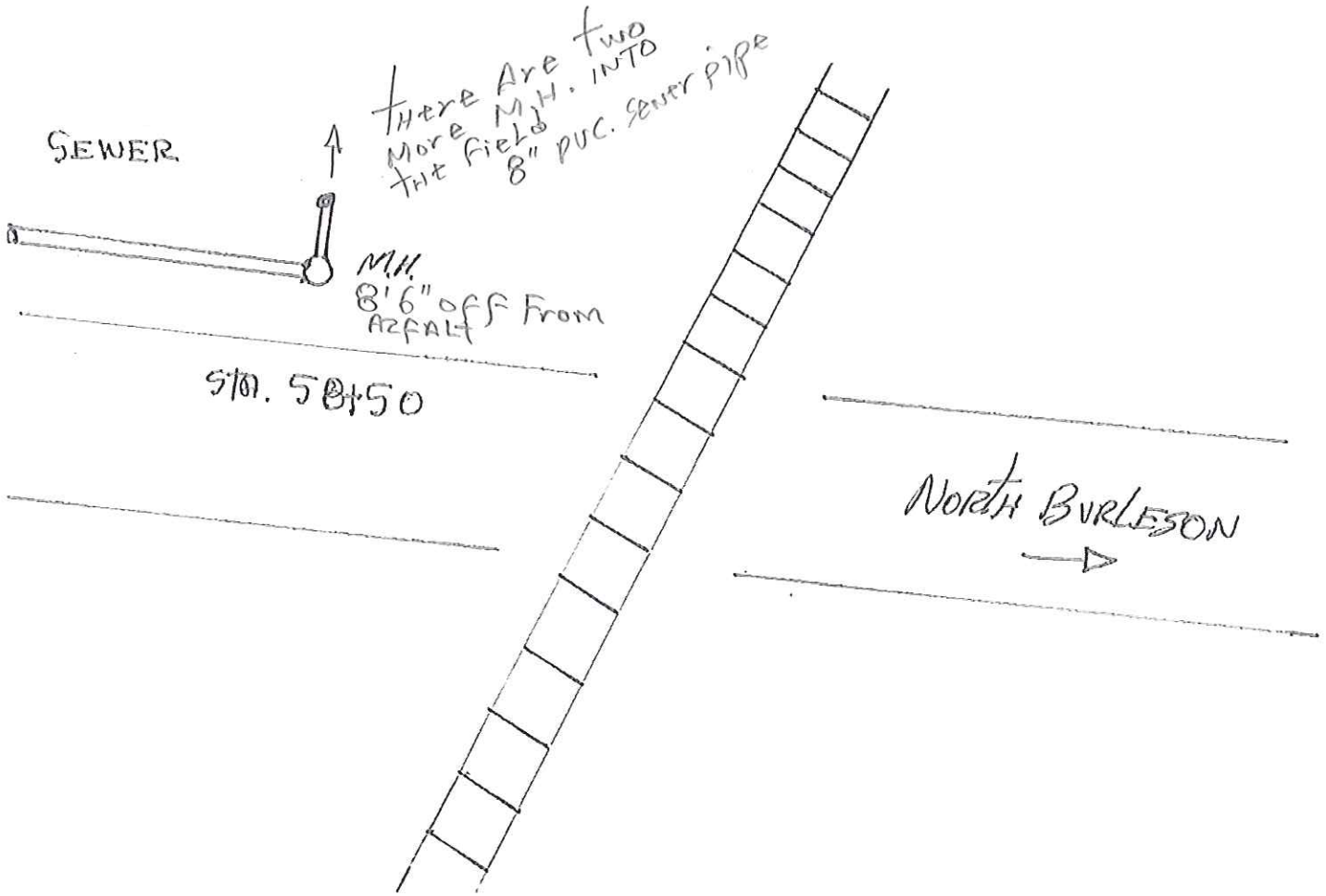

What is this line? Size,  
location?

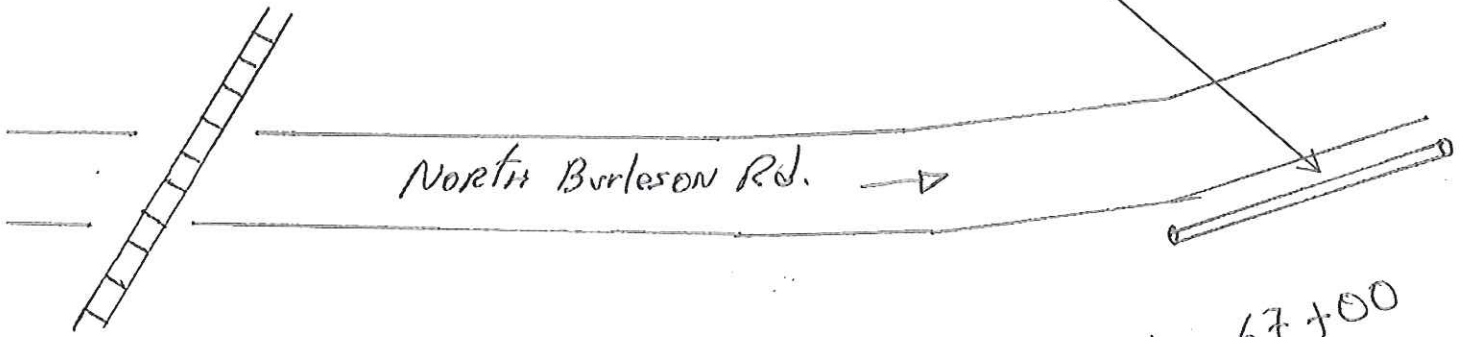

Sta 67+00  
8" PVC Water Ln.  
O.D. 9.08  
9' off Asphalt  
3' 5" Deep